

PLAN OF LAND UNDER MOUZA:- NILKANTHPUR  
@ NOORPUR NO-415 WITHIN DEOGHAR NAGAR  
NIGAM WARD NO- 27 J. B.NO- 20 T. P. PLOT NO- 6/15, 7,  
6/1, 6/2, 7/1 & 7/2 SUB PLOT NO- 1 AREA-3429sqft. SHOWN  
IN RED COLOUR BELONG'S TO Smt. ANJALI  
MUKHARJEE W/O LATE CHANDRA SHEKHAR  
BANERJEE & SRI ANINDAM MUKHARJEE S/O LATE  
CHANDRA SHEKHAR BANERJEE & NOW SOLD TO SRI  
NIYAS CHANDRA TIWARY S/O SRI BHARAT PRASAD  
TIWARY OF SALAMPUR, P.S- AMERPUR DIST- BANKA.



CIRCULAR ROAD

*Anindam Mukherjee*  
*11/10/12*

MUNICIPAL PROPOSED ROAD

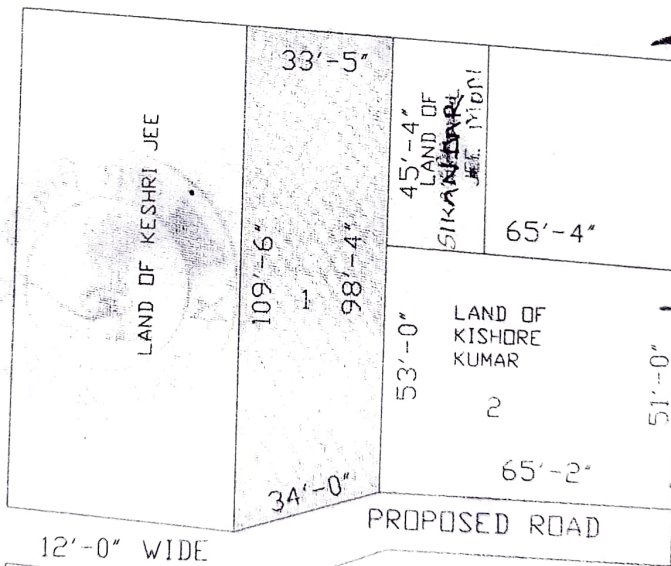

*Anindam Mukherjee*

1840

*Anjali Mukherjee*  
*11.10.12*

TESTED  
 8/08/12  
 NOTARY (REGD NO. 12504)  
 GOVT OF BIHAR, INDIA  
 PATNA, INDIA

*Travis*  
*11/10/12*