

PROPOSED COMMERCIAL B.U.G.S STORED ROOF RIB DING FOR SANJAY KUMAR AND ANJANI PRAKASH

**FRONT ELEVATION**  
**R.H.S. ELEVATION**

**4TH & 5TH FLOOR PLAN**  
**TERRACE FLOOR PLAN**

**FIRST FLOOR PLAN**  
**2ND & 3RD FLOOR PLAN**

**BASEMENT FLOOR PLAN**  
**GROUND FLOOR PLAN**

**SECTION ON A-A**  
**SECTION ON B-B**

**SECTION AT A-A'**  
**SCALE 1:100**

**PLAN OF S.U.G.W.R**  
**SCALE 1:100**

**DETAIL OF GROUND WATER RECHARGING PIT WITH SILT TANK**  
**SCALE - N.T.S.**

SPACE FOR R.M.C SEAL

This certifies that the structure design is in accordance with the latest I-S code (I-S 8731-1480-2002, I-S 1883-2000) for design & loading conditions (Design/Wind/Seis/Env) and other all parameters are taken in account for safety of the structure.

**BRIEF SPECIFICATION**

- BRICK WORK IN FOUNDATION & SUPERSTRUCTURE
- FIRST CLASS BRICK WORK IN CEMENT MORTAR (1:0)
- D.P.C. - D.P.C. IN CEMENT CONCRETE (1:2:4)
- FLOOR - (a) 1" F.P.S. (b) MOSAIC FLOORING
- ROOF - 5" THK. R.C.C. ROOF (1:1.5:3)
- LINTEL BAND AT 3' LVL. - 6" THK. R.C.C. LINTEL (1:1.5:3)
- STAIRS ROSE - 4" TREAD - 10"
- DOORS - D-3'3"x7'0", D1-3'0"x7'0", D2-4'0"x7'0"
- WINDOWS - W-5'0"x4'0", W1-4'0"x4'0", W2-5'0"x4'0"
- VENTS - 2'0"x2'0"
- SAL WOOD FRAME & PAISAL WOOD SHUTTERS SHALL BE USED FOR DOOR
- ALUMINIUM GLAZED WINDOW AND VENTILATORS WITH GLAZED BARS SHALL BE USED
- F.P.S. FLOOR SHALL BE USED OVER R.C.C. SLAB/P.C.C.
- ALL MASONRY SURFACES SHALL BE PLASTERED WITH CEMENT MORTAR 1:0.8 C.C. WITH CEMENT MORTAR 1:4 IN ROOF
- ALL STEEL AND WOOD WORK SHALL BE PAINTED WITH SYNTHETIC PAINT
- ALL SANITARY AND ELECTRICAL FITTINGS SHALL BE OF STANDARD AND COMMERCIAL QUALITY

**SCHEDULE OF DOORS AND WINDOWS**

Type	Width	Height	Level	Description
D1	1.173	2.100	2.100	shutter
D2	1.000	2.100	2.100	double shutter panel door
D3	1.000	2.100	2.100	single shutter panel door
D4	1.000	2.100	2.100	single shutter panel door
D5	1.173	2.100	2.100	double shutter panel door
W	1.200	1.200	2.100	4 leaf glazed shutter
W1	1.000	1.000	2.100	4 leaf glazed shutter
W2	0.750	1.200	2.100	4 leaf glazed shutter
V	600	400	2.100	ventilation

**PROJECT**

PLAN SHOWING PROPOSED COMMERCIAL BUILDING FOR SANJAY KUMAR AND ANJANI PRAKASH S/O SRI AYODHAYA PRASAD, LAND UNDER MOUZA - KLUNDA, NO - 409, J.B. NO - 47/34, PRESENT J.B. NO - 47/34/1, PART OF PLOT NO 586 & 578, WITHIN DEOGHAR NAGAR NIGAM, DEOGHAR, JHARKHAND.

DESIGNED & CHECKED BY: UJJWAL KUMAR scale: 1:100  
DRAWN BY: HASR AHMAD  
DATE: 10/01/2024

ARCHITECT: \_\_\_\_\_ CLIENT: \_\_\_\_\_

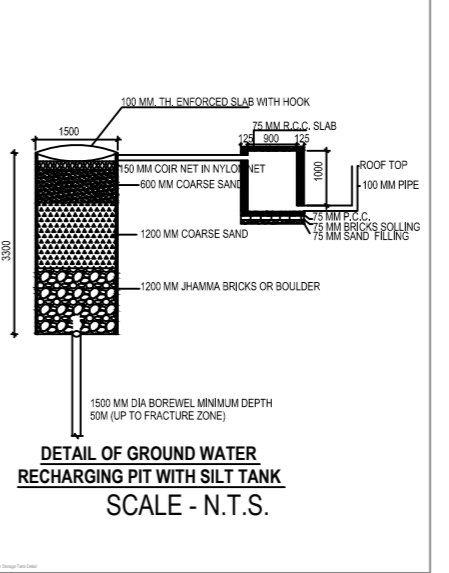
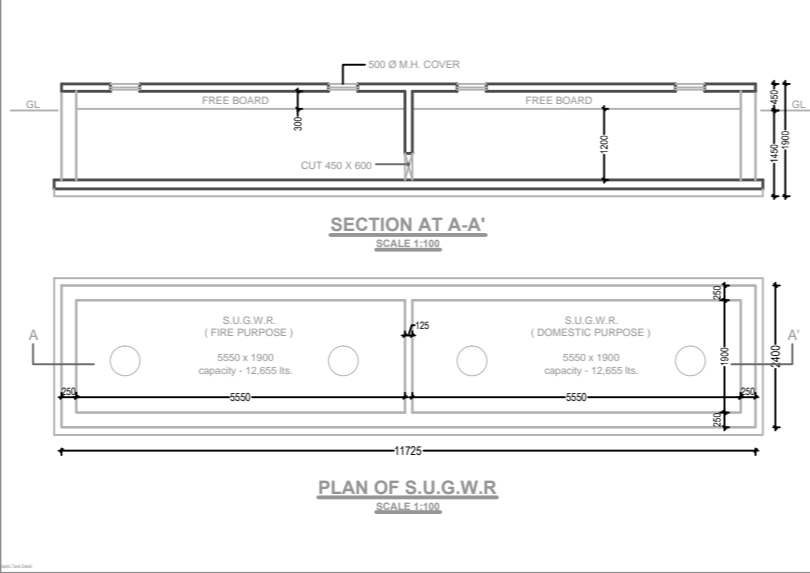
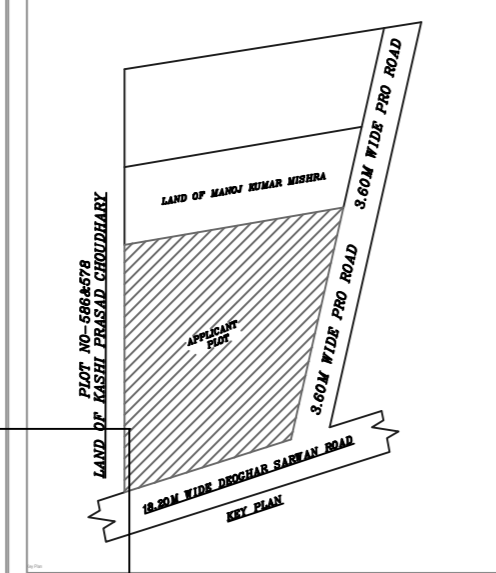
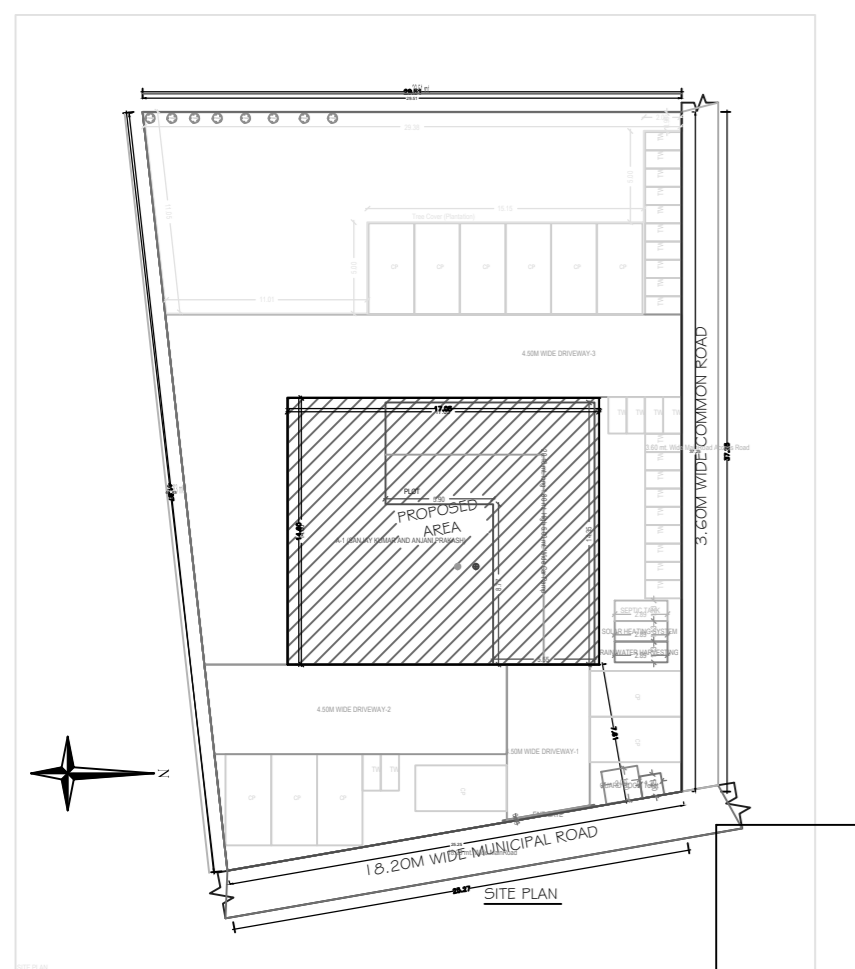

Building & Structural Formwork and Shuttering Tables

Sl. No.	Part	Area (sq. m)	Volume (cu. m)	Weight (kN)	Remarks
1	Formwork	1000	1000	1000	
2	Shuttering	500	500	500	
3	Bricks	2000	2000	2000	
4	Mortar	1000	1000	1000	
5	Concrete	1000	1000	1000	
6	Steel	1000	1000	1000	
7	Wood	1000	1000	1000	
8	Other	1000	1000	1000	
9	Total	10000	10000	10000	

Color Index

Color	Code
White	W
Black	B
Red	R
Green	G
Blue	B
Yellow	Y
Purple	P
Brown	Br
Grey	Gr
Orange	O
Pink	Pk
Light Blue	LB
Light Green	LG
Light Red	LR
Light Yellow	LY
Light Purple	LP
Light Brown	LBr
Light Grey	LGr
Light Orange	LO
Light Pink	LPk
Light Light Blue	LLB
Light Light Green	LLG
Light Light Red	LLR
Light Light Yellow	LLY
Light Light Purple	LLP
Light Light Brown	LLBr
Light Light Grey	LLGr
Light Light Orange	LLO
Light Light Pink	LLPk