

Plan of Land situated at Abaya - Mahalingudi, Mauje No. 592  
 in the Deeglar Nagar Nizam Road No-28. P.S. Sub-Division  
 and Dist - Deeglar. Details of Land shown hereunder below.

From Kurnar Singhania  
 to Kurnar Singhania

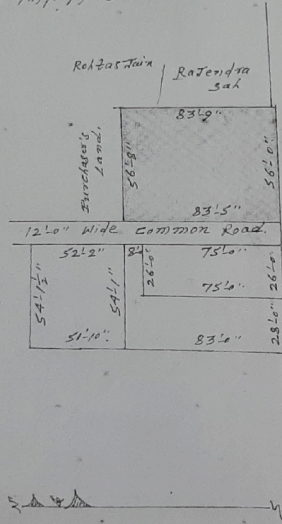

Deeglar to Dumka Road

Sl. No.	Plot No.	Name of owners	Name of Inchores	Remarks
1	301, 302 (Part)	1. Sri. Dilli K. Singhania 2. Sri. Prem K. Singhania 3. Sri. Prasad Singhania 4. Sri. Hemant Singhania 5. Sri. Sub. Division and Dist - Deeglar	Sri. Kurnar Singhania Sri. Prem K. Singhania Sri. Hemant Singhania Sri. Sub. Division and Dist - Deeglar	Shaded in Red Color in map.

12.0' wide common Road  
 DEEGAR  
 DIST - DEEGAR

Deeglar

Deeglar

PLAN OF LAND UNDER MOUZA:- JHOUNSAGARHI  
 NO-582 WITHIN DEOGHAR MUNICIPAL WARD NO- 4  
 JLN NO-569 PART OF T. P. PLOT NO- 301 & 302 AREA  
 IS SHOWN IN RED COLOUR BELONG'S TO SRI  
 BHEEP KUMAR SINGHANIA & SRI PREM KUMAR  
 SINGHANIA BOTH S/O LATE PURAN MAI SINGHANIA  
 & NOW SOLD TO Smt. RENU SINGHANIA W/O SRI  
 PREM KUMAR SINGHANIA OF JHOUNSAGARHI,  
 DEOGHAR.

*21/02/09*  
*21/02/09*  
*21/02/09*

*Atish Kumar Singhania*  
*Pradyuman Singhania*  
*Pradyuman Singhania*  
*Pradyuman Singhania*

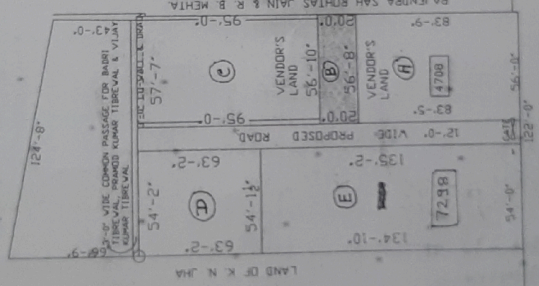

DEOGHAR TO DUMKA ROAD

*7/12/09*  
*7/12/09*  
*7/12/09*

*Atish Kumar Singhania*

*Renu Singhania*

DEOGHAR MUNICIPAL WARD NO- 4  
 JHOUNSAGARHI  
 JLN NO-569

PLAN OF LAND UNDER MOUZA- JHOUNSAGARHI  
 NO-582 WITHIN DEOGHAR MUNICIPAL WARD NO- 4  
 I.B.NO- 569 PART OF T. P. PLOT NO- 301 & 302 AREA/  
 5434sqft. SHOWN IN RED COLOUR BELONG'S TO SRI  
 DILIP KUMAR SINGHANIA & SRI PREM KUMAR  
 SINGHANIA BOTH S/O LATE PURAN MAL SINGHANIA  
 & NOW SOLD TO Smt. RENU SINGHANIA W/O SRI  
 PREM KUMAR SINGHANIA OF JHOUNSAGARHI  
 DEOGHAR.

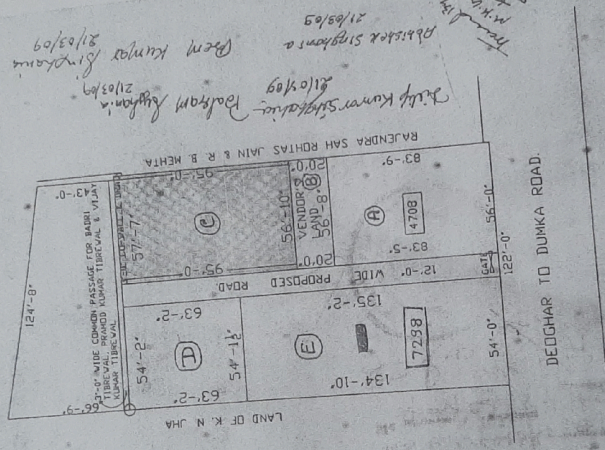

प्लॉट नं. 301 & 302 का हिस्सा  
 प्लॉट नं. 301 & 302 का हिस्सा  
 प्लॉट नं. 301 & 302 का हिस्सा

प्लॉट नं. 301 & 302 का हिस्सा  
 प्लॉट नं. 301 & 302 का हिस्सा  
 प्लॉट नं. 301 & 302 का हिस्सा

प्लॉट नं. 301 & 302 का हिस्सा  
 प्लॉट नं. 301 & 302 का हिस्सा

DEOGHAR TO DUMKA ROAD.