

PLAN OF LAND UNDER MOUZA-JHONSAGARHT, NO-582,
 UNDER DEOGHAR MUNICIPAL, WARD NO-4, DIST-DEOGHAR
 UNDER TB NO-267, PART OF PLOT NO-7 & 9, AREA-1252-38
 SQ FT SKETCHED IN RED COLOUR, BELONGS TO SHREE BINOD
 KUMAR, S/O LATE RAMAR NATH SHAH OF BILAST TOWN
 B DEOGHAR, AND NOW SOLD TO SMT SATYAWATI DEVI
 W/O SHREE ASHOK KUMAR, AT MUJALLA-KATRACHAK,
 GOLA ROAD, PS. DIVISION AND DIST. SEKHAPURA.
 (SCALE - 1 INCH = 10 FEET)

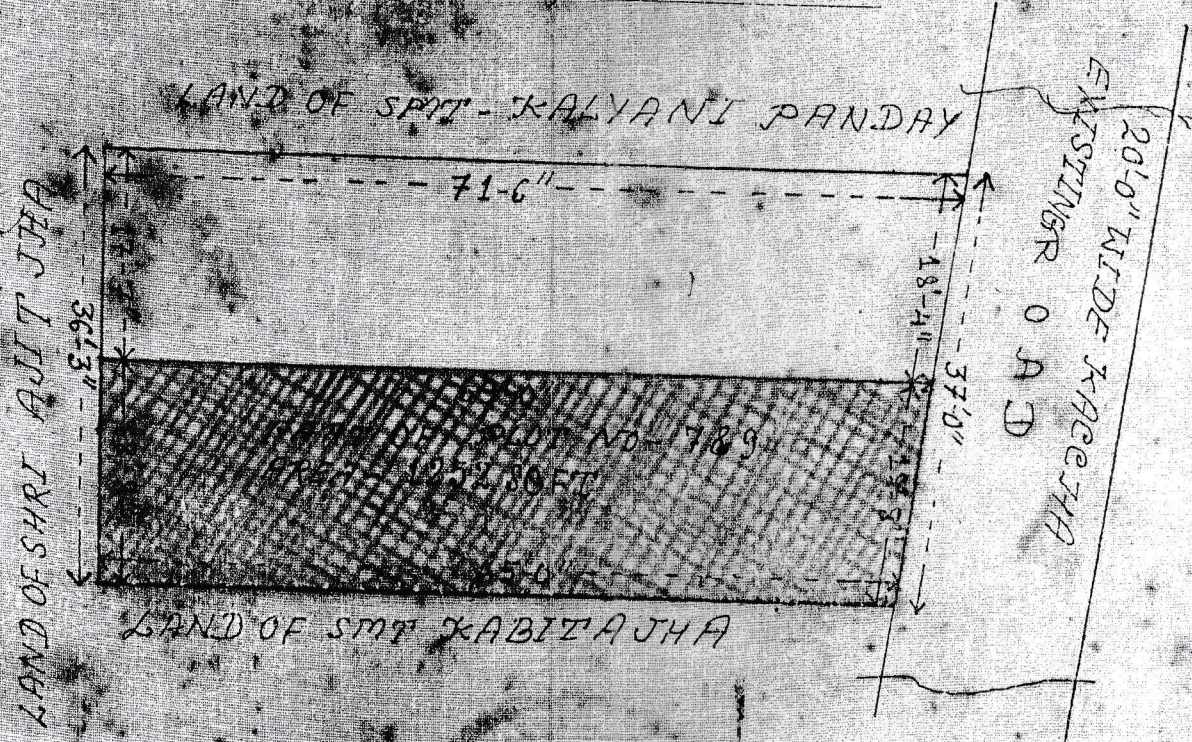

LAND OF SHRI AJIT JHA
 36'-3"
 71'-6"
 107'-9"
 37'-0"
 20'-0"
 127'-9"

16/10/2000

Inwch By:-
 Ch. N. Agrawal
 16-10-2000

ATTESTED
 (REGD NO. 27115)
 GOVT OF JHARKHAND
 DIST DEOGHAR (INDIA)

सच 9/10/2000