

PLAN OF LAND UNDER MOUZA:- BARIARBANDHI NO- 400 WITHIN DEOGHAR NAGAR NIGAM WARD NO- 35 JAMABANDI NO- 32/12, PRESENT JAMABANDI NO- 9/3449 PART OF SURVEY PLOT NO- 390, SUB PLOT NO- 3 & 9 AREA:- AREA-2928sqft. SHOWN IN RED COLOUR BELONGS TO Smt. KUSUM KESHRI & OTHERS & NOW SOLD TO SRI NAVEEN JAISWAL S/O LATE BALRAM PRASAD SAH OF BRIJ BIHARI LANE, B. DEOGHAR, JHARKHAND.

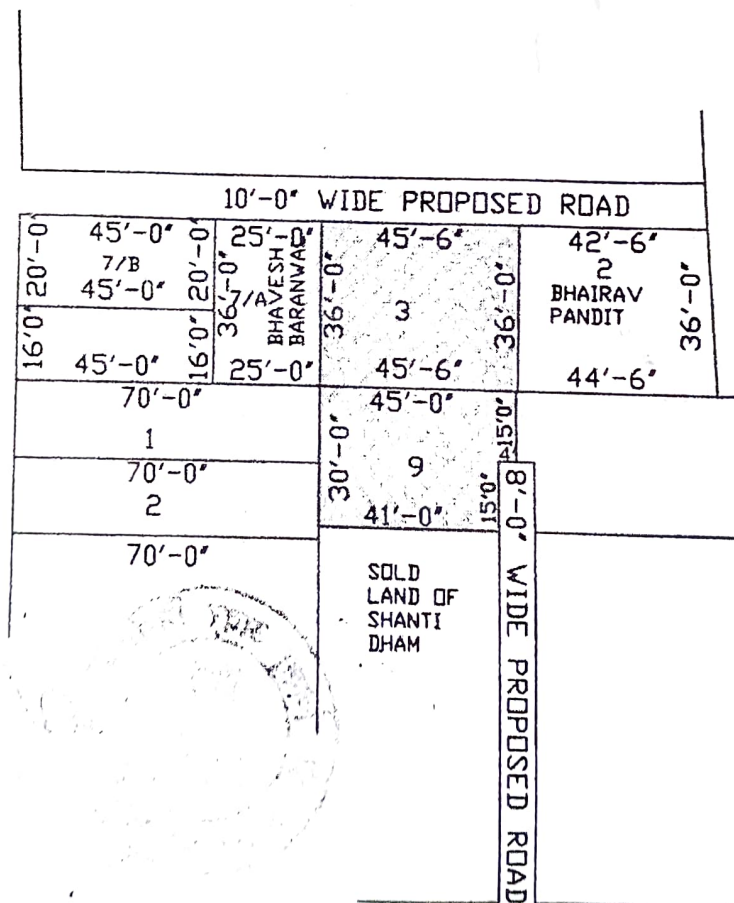

SETH SURAJ MAL JALAN ROAD



Handwritten signatures and notes:
 Smt. Kusum Keshri
 Sri Naveen Jaiswal
 Sandhya Keshri

Handwritten note:
 Trace of 1/11