

VILLAGE - CHAKLA
 THANA NO - 32 *Original*
 THANA - ORMANSHI
 DIST - RANCHI
 P.S. PUT N - 1036
 SHOWN IN RED WASH

AREA
 SUBPLOT N A-DEF
 1036/PART - 0-52

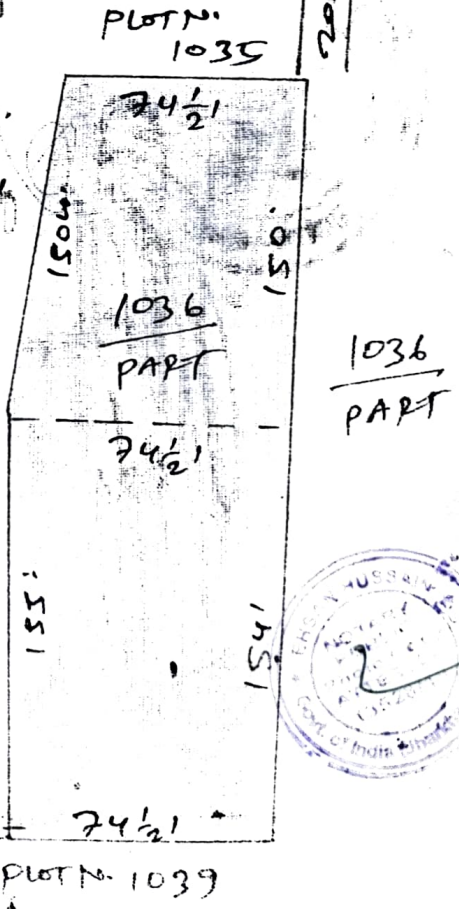
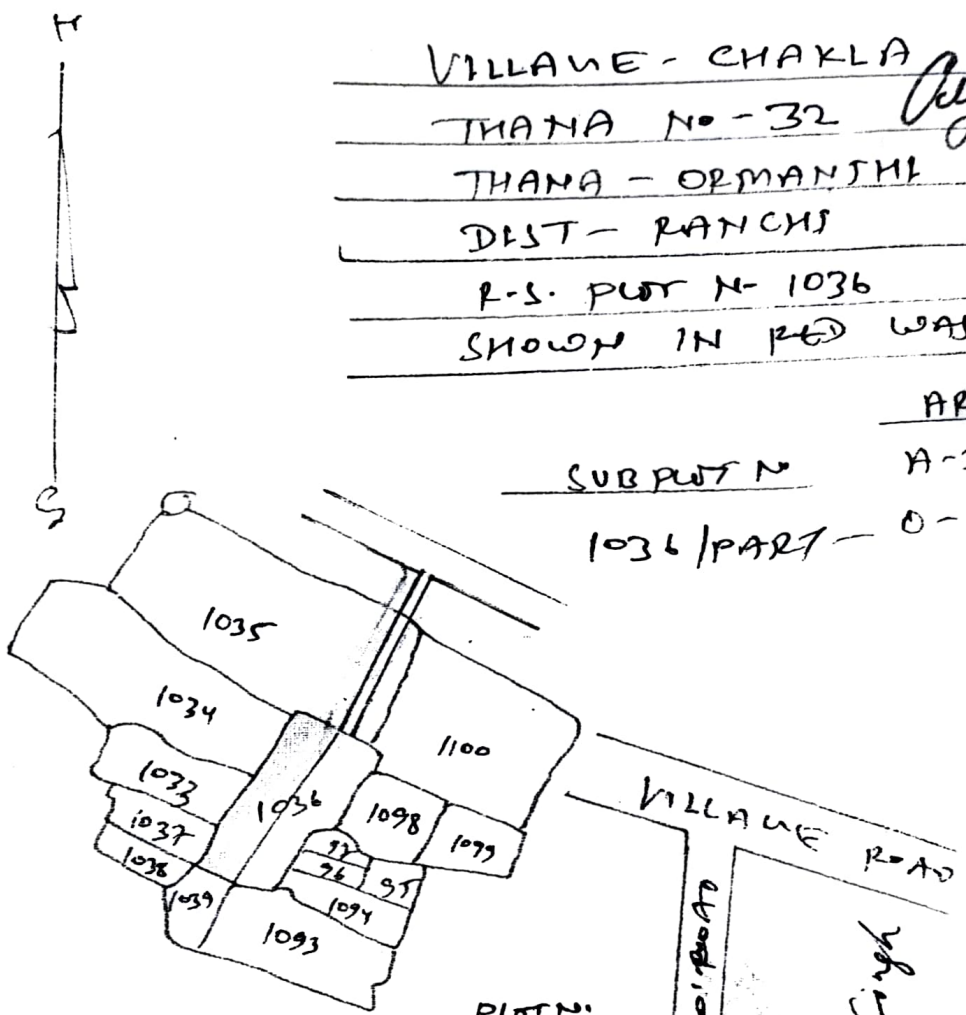

P.N.
1034
P.N.
1033

P.N.
1037

1036
PART

Krishna Gopal Singh
 Anand Sankar Singh



[Signature]

[Handwritten marks]

[Handwritten marks]