

SCHEDULE OF OPENINGS		
TYPE	SIZE	DESCRIPTION
D	1.07X2.10	Sal wood chaukhat & Commercial Ply Shutter
D-1	1.00X2.10	Sal wood chaukhat & Commercial Ply Shutter
D-2	0.90X2.10	Sal wood chaukhat & Commercial Ply Shutter
D-3	0.75X2.10	Sal wood chaukhat & Commercial Ply Shutter
W	1.50X1.20	Fully glazed Al. Sliding window
W-1	1.20X1.20	Fully glazed Al. Sliding window
V	0.60X0.60	

- SPECIFICATION**
- R.C.C.(1:2:4) IN COLUMN FOUNDATION WITH R.C.C. TIE BEAM
 - SUPER STRUCTURE 1ST CLASS BRICK WORK IN C.M (1:6)
 - R.C.C.(1:2:4) IN LINTEL CHAJIA, ROOF SLAB, STAIRCASE COLUMN E.T.C, AS PER DESIGN ENGINEER.
 - SAL WOOD CHAUKHAT IN DOORS & ALUMINIUM FRAME IN WINDOWS.
 - 12 MM CEMENT PLASTER IN C.M.(1:4) INSIDE & OUTSIDE WALL SURFACE.
 - 6MM CEMENT PLASTER IN C.M.(1:4) IN CEILING.
 - DOOR SHUTTER- COMMERCIAL PLY FLUSH DOOR SHUTTER.
 - WINDOW SHUTTER ALUMINIUM GLAZED SLIDING PANNEL.
 - CERAMICS TILES FLOORING IN ALL ROOMS.

AREA CALCULATION (IN SQ.MTR.)	
TOTAL PLOT AREA	= 220.15 sq.mt
GROUND FLOOR AREA	= 143.00 sq.mt
FIRST FLOOR AREA	= 145.90 sq.mt
SECOND FLOOR AREA	= 145.90 sq.mt
TOTAL BUILT-UP AREA	= 434.80 sq.mt
% OF COVERAGE	= 65.00%
F.A.R.	= 1.98

PROPOSED RESIDENTIAL BUILDING PLAN FOR SMT. SARITA RAI, W/O- SRI ABHAY KUMAR IN MOUZA- TETULIA, P.S.- SEC- 12, P.S. NO- 38, DISTT- BOKARO (JHARKHAND) UNDER KHATA NO.- 40 PLOT NO.- 383 & 384 AREA- 5.44 DECIMAL.

SIGNATURE OF APPLICANT:- SIGNATURE OF ENGINEER :-

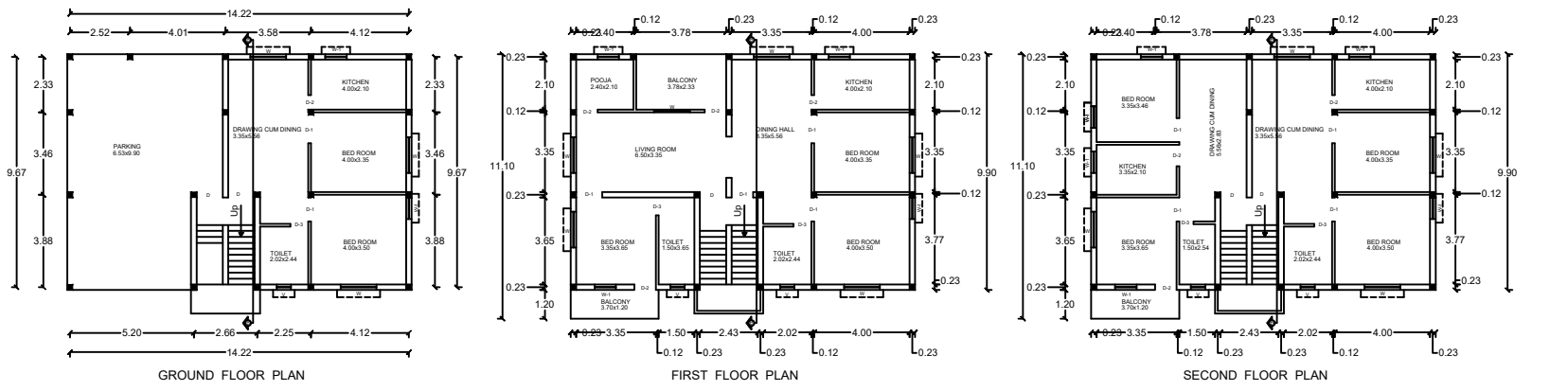

ALL DIMENSION ARE IN METER