

Vender) 1. SRI BISHWAMBHAR BISHWAKARMA (Adhar No.5347 1282 4128) 2. SRI BHUDEV VISHWAKARMA (Adhar No.4460 9477 1431) 3. SRI HIRA LAL VISHWAKARMA (Adhar No.3613 7969 4065) 4. SRI PRABHU PRASAD VISHWAKARMA, (Adhar No.2418 0092 1121), all sons of Late Guhiram Mistry, by faith Hindu, by caste Loхар, by occupation Cultivation etc.,resident of Upper Bazar Gobindpur, P.O. & P.S. Gobindpur, District Dhanbad, Jharkhand, hereinafter called and referred to as the VENDORS are represented by their constituted attorney, SRI SUMIT KUMAR SINGH (Aadhar No. 4777 1529 8855) S/O Sri Harendra Prasad Singh, by caste Rajput, by occupation Business, resident of LA 106, Rameshwar Bhawan, Main Road, Saraidhela, P.S. Saraidhela, District Dhanbad, Jharkhand

(Vendee) SMT JYOTI KUMARI (Adhar No. 282605517093 & PAN: BIWPK9779D D/O of Sri Laljee Prasad , wife of Sri Sujeet Kumar Sinha, by faith Hindu, by caste Kayasth, by occupation Housewife, resident of HNo WB/94 Gayatri Colony P.O.- kathara, P.S.- bokaro, District Bokaro, Jharkhand, hereinafter called and referred to as the PURCHASER

SCHEDULE - MOUZA : JEALGORA, Mouza No.129,

NEW KHATA NO.133, NEW PLOT NO.1446, area 2.57 dec. (Two point Fifty Seven decimals) or to say 1118 Sq.Ft. of residential land.



Which is butted and bounded as flows:-

North : Part of this Plot.

South : Part of this Plot.

East : Proposed Road.

West : Part of this Plot.

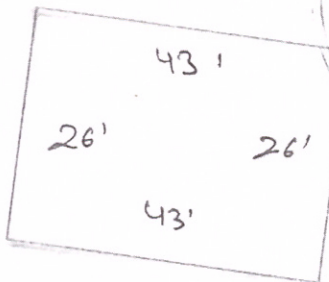

Which is shown in colour red.

$\frac{26}{26} = 1$   
 Net to Sec

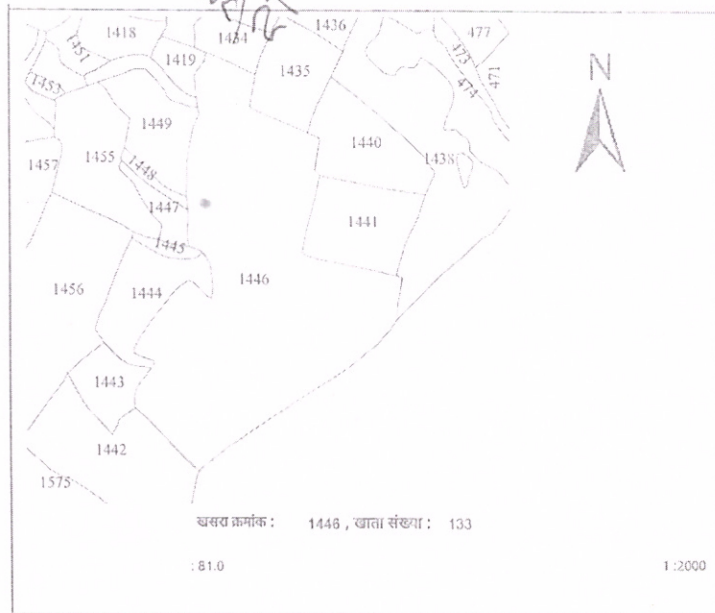

*Handwritten signature and notes on the right side of the map.*

*Jyoti Kumari*

