

VENDOR :- M/S EMPYREAN ABODES A PARTNERSHIP FIRM ITS OFFICE AT GREWAL COLONY BEKAR BANDH P.S. DHANBAD DIST DHANBAD REPRESENTED BY ITS PARTNERS - (1) SRI RAMESH KUMAR RITOLIA SID LATE JAGDISH PRASAD RITOLIA (2) SRI GAUTAM KUMAR ADWANI (3) SRI HEMANT KUMAR ADWANI SID SRI GURDINOMAL ADWANI (4) SRI MAHESH KUMAR ADWANI SID SRI UTTAM CHANDADWANI NO 1. RESIDENT OF GREWAL COLONY BEKAR BANDH P.S. DHANBAD. DIST DHANBAD & R.TOS DE NEAR SINDHI GURUDWARA JORAPATAK ROAD DHANBAD. P.S. DHANSAR DIST DHANBAD

VENDEE :- SMT HIRAN DEVI WID SRI JITENDRA KUMAR SINGH OF OLD STATION NEAR GIRLS ACADEMY SCHOOL. GAJURTANO. P.S. DIST DHANBAD.

SHEDUL :- MAUZA :- NARAYANPUR ALIAS PIDRABERA MAUZA NO. 13. NEW. KHATA NO. 140. NEW. PLOT NO. 480. OLD. KHATA NO. 5. OLD. PLOT NO. 253. AREA - 4. KATHA OR. 6.60. DICMAL.

BOUNDARY :- NORTH :- NEW. PART OF PLOT NO. 480.
 SOUTH :- NEW. PLOT NO. 480 (PART)
 EAST :- RASTA.
 WEST :- NEW. PLOT NO. 472.

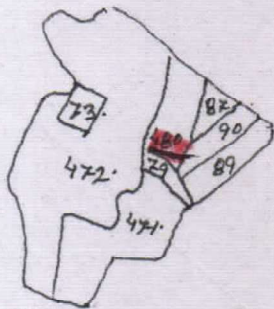

NEW MAP KEY PLAN
 SCALE 1" = 330'-0"

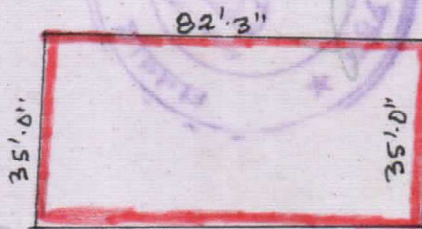

SITE PLAN
 NOT TO SCALE

Ranjit K. Kishore
 27/01/20

Jagan Kumar Adwani
 27/01/20

Sri Hemant Kumar Adwani
 27/01/20

Rajendra Kumar Adwani
 27/01/20

TRACED BY
 K.K. Suresh
 AMIN