

SELLAR:- U SRI RABINDRA KUMAR SINGH S/O LATE RAGHO SINGH
AT BHULI B/122, PO- BHULI NAGAR, PS- BANK MORE DIST-DHANBAD.

PURCHASER:- SMT JYOTI DEVI W/O SRI BHIM SINGH AT-RANGUNI
PS- TETULMARI, DIST - DHANBAD.

SCHEDULE :- MOUZA - BOUAKALA MOUZA No - 228 KHATA No OLD
41, NEW KHATA No - 27 PLOT No 1486 NEW PLOT No - 1612 SELL
AREA. 1 DICMILE PLOT No 1487 NEW PLOT No 1613 SELL AREA
2.30 DIC TOTAL 3.30 DIC OR 2 KATTA.

BOUNDRY N - HIRAK ROAD S - PART PLOT
E - DIPAK KUMAR W - B. K. SINGH

Red Mark Map shown for sale —

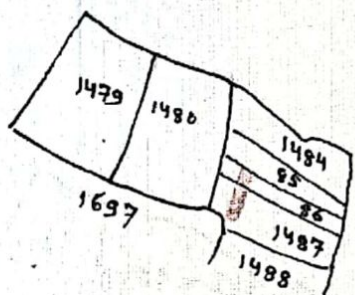
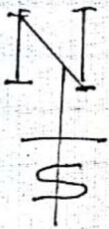

TRUE COPY
SCALE : 1" = 330'.0"

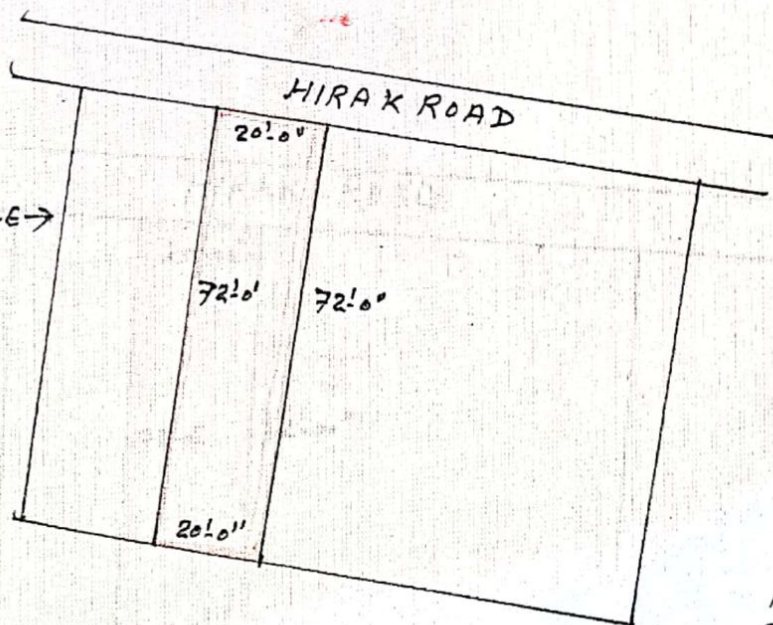

Prepared by
Sheo Narain Jha
AMIN

BUYER :- SRI RABINDRA KUMAR SINGH aka LATE RACHO SINGH
BHULLI 8112, P.O. BHULLI NAGAR, P.S. BANGKUMORE DIST - DHANBAD.

PURCHASER :- SMT JYOTI DEVI W/O SRI BHIM SINGH AT - RAHAGUNI
PR - TETULMARI, DIST - DHANBAD.

SCHEDULE :- MOUNA - BOUKALA MOUNA NO - 258 KHATA NO 612
A1, NEWKHATA No - 27 PLOT No 198 NEW PLOT No - 1612 SELL
AREA 1210 MILE PLOT No 198 NEW PLOT No 1612 SELL AREA
2.30 DIT TOTAL 2.30 DIT IN 2 KHATA.

BOUNDARY N - HIRAK ROAD 2 - PART PLOT
E - DEEPAK KUMAR W - B.K. SINGH

Red Mark map shown for sale

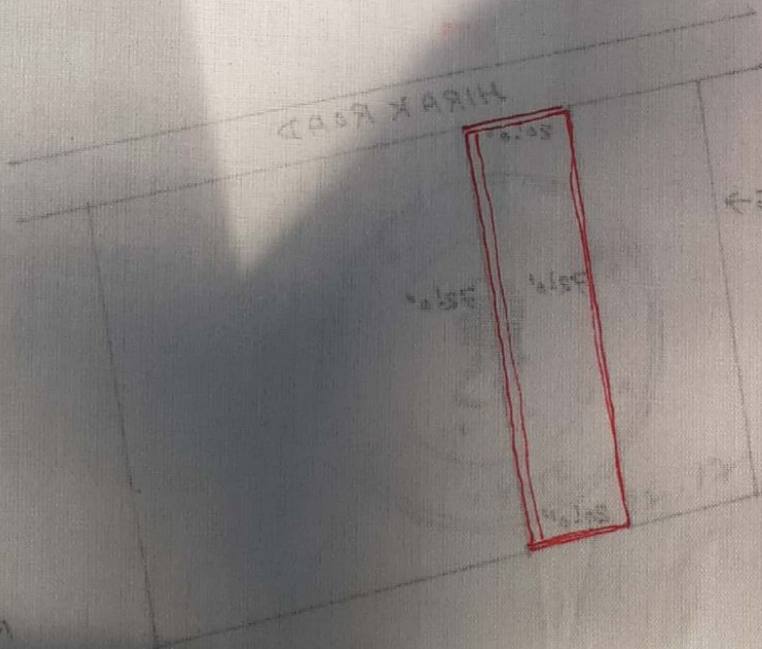
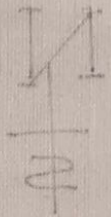

TRUE COPY
SCALE: 1:25000