

The part of this land is Rayti Under Dhanbad Anchal Mouza  
 No- 13 Narayampur new khata no- 124 New Plot no- 523  
 Area 15 Katha or 24.80 Decimals which is shown in red colour  
 It's Continuous Khata owner name is Mr. Sahdev Singh  
 S/o- Hukum Sai at Kolakuma, Saraidihela, Dhanbad,  
 Jharkhand.

Boundary → North → New Plot no- 724  
 South → Part Plot of 523 (New)  
 East → New Plot no- 724  
 West → 25'-0" wide Road

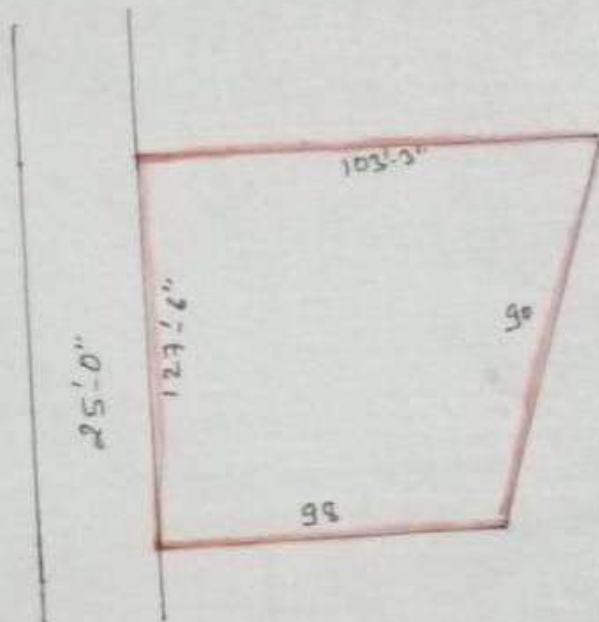

Site Plan not to scale

Trace by  
 Anon