

BRIEF SPECIFICATION

FOUNDATION :- R.C.C. (1:1.5:3) Column footing foundation
 PLINTH :- 12th R.C.C. (1:1.5:3) all round on plinth level
 FLOORING :- 1.5th 1.P.S. flooring over 3th P.C.C (1:3:1)
 SUPER STRUCTURE :- First class brick work in cement mortar (1:6)
 SLAB/BEAM & LINTEL :- All R.C.C. work (1:1.5:3)
 WOOD WORK :- All door & window frames of sal wood.
 PLASTERING :- 0.5th cement plaster (1:6) both side.

SCHEDULE

D -	1.000 X 2.100	W -	1.500 X 1.200
DI -	0.900 X 2.100	WI -	1.200 X 1.200
D2 -	0.750 X 2.100	W2 -	0.900 X 1.200
		V -	0.600 X 0.600

DETAILS OF AREA

TOTAL AREA (AS PER DEED)	16882 Sq
TOTAL AREA (AS PER SITE)	16629 Sq
GROUND FLOOR AREA	104.15 Sq
FIRST FLOOR AREA	105.76 Sq
SECOND FLOOR AREA	105.76 Sq
TOTAL COVERED AREA	314.67 Sq
% OF PLINTH AREA	62.57%
E.A.R	1.89

TITLE OF DRAWING

PLAN OF RESIDENTIAL BUILDING OF
 SMT SHOBHA SINHA, W/O SRI KRISHNA KUMAR
 ETWARI NAGAR, TELIWARA, HIRAPUR, (DHANBAD)
 UNDER MOUZA - DAMODARPUR NO- 14, OLD KH/1
 NO- 27, NEW KHATA NO- 180, OLD PLOT NO- 87
 NEW PLOT NO.- 1863, DIST- DHANBAD, (JHARKHA)

SIG. OF OWNER

SIG. OF ENGINEER

DRG. AT:-

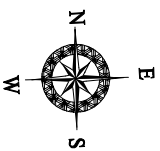
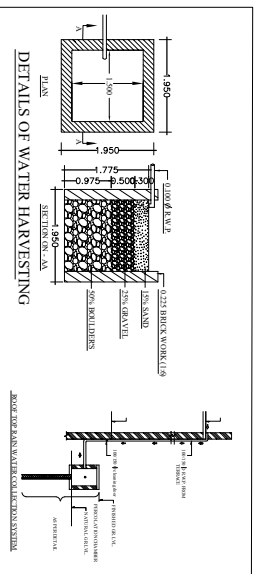
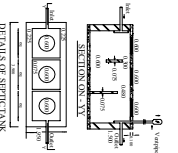
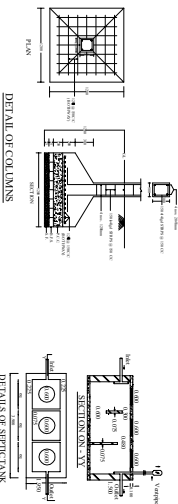
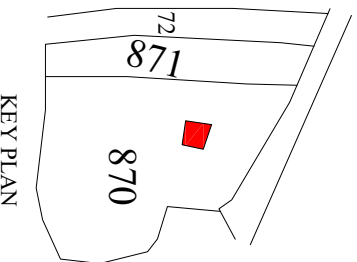
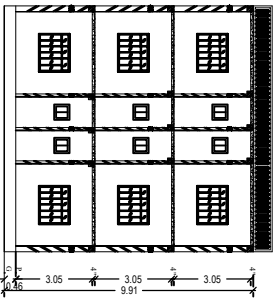
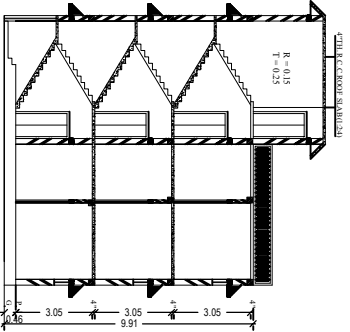
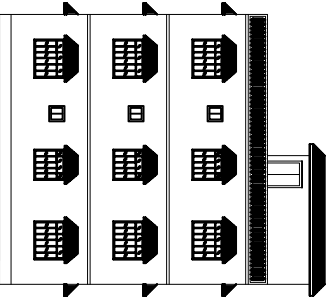
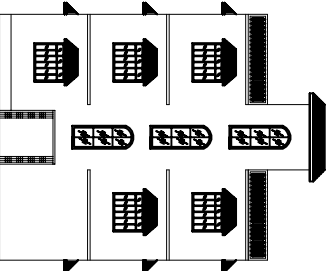

BRIEF SPECIFICATION

FOUNDATION :- R.C.C. (1:1.5:3) Column footing foundation
 PLINTH :- 12th R.C.C. (1:1.5:3) all round on plinth level
 FLOORING :- 1.5th 1.P.S. flooring over 3th P.C.C (1:3:1)
 SUPER STRUCTURE :- First class brick work in cement mortar (1:6)
 SLAB/BEAM & LINTEL :- All R.C.C. work (1:1.5:3)
 WOOD WORK :- All door & window frames of sal wood.
 PLASTERING :- 0.5th cement plaster (1:6) both side.

SCHEDULE

D -	1.000 X 2.100	W -	1.500 X 1.200
DI -	0.900 X 2.100	WI -	1.200 X 1.200
D2 -	0.750 X 2.100	W2 -	0.900 X 1.200
		V -	0.600 X 0.600

DETAILS OF AREA

TOTAL AREA (AS PER DEED)	16882 Sq
TOTAL AREA (AS PER SITE)	16629 Sq
GROUND FLOOR AREA	104.15 Sq
FIRST FLOOR AREA	105.76 Sq
SECOND FLOOR AREA	105.76 Sq
TOTAL COVERED AREA	314.67 Sq
% OF PLINTH AREA	62.57%
E.A.R	1.89

TITLE OF DRAWING

PLAN OF RESIDENTIAL BUILDING OF
 SMT SHOBHA SINHA, W/O SRI KRISHNA KUMAR
 ETWARI NAGAR, TELIWARA, HIRAPUR, (DHANBAD)
 UNDER MOUZA - DAMODARPUR NO- 14, OLD KH/1
 NO- 27, NEW KHATA NO- 180, OLD PLOT NO- 87
 NEW PLOT NO.- 1863, DIST- DHANBAD, (JHARKHA)

SIG. OF OWNER

SIG. OF ENGINEER

DRG. AT:-

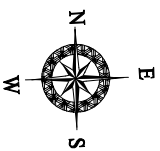
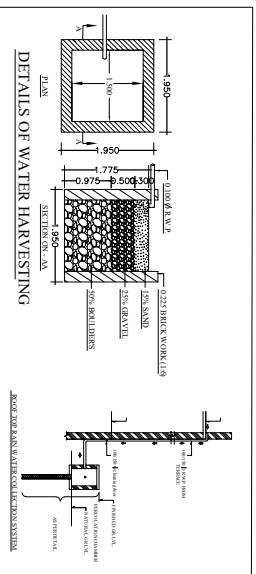
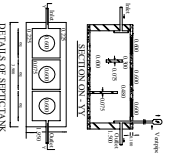
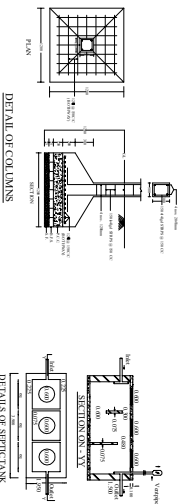
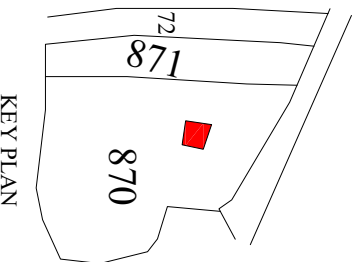
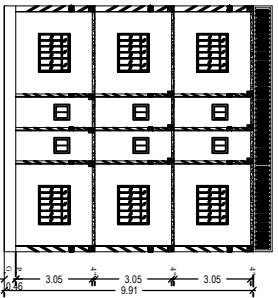
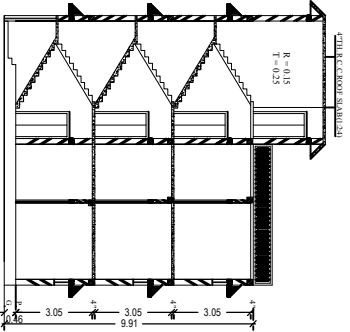
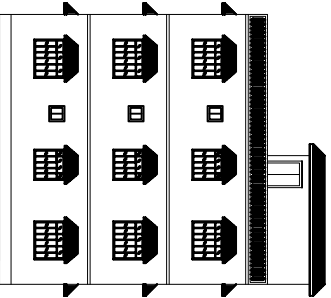
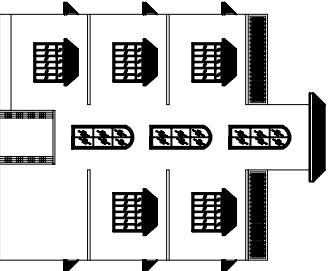

BRIEF SPECIFICATION

FOUNDATION :- R.C.C. (1:1.5:3) Column footing foundation
 PLINTH :- 12th R.C.C. (1:1.5:3) all round on plinth level
 FLOORING :- 1.5th 1.P.S. flooring over 3th P.C.C (1:3:1)
 SUPER STRUCTURE :- First class brick work in cement mortar (1:6)
 SLAB/BEAM & LINTEL :- All R.C.C. work (1:1.5:3)
 WOOD WORK :- All door & window frames of sal wood.
 PLASTERING :- 0.5th cement plaster (1:6) both side.

SCHEDULE

D -	1.000 X 2.100	W -	1.500 X 1.200
DI -	0.900 X 2.100	WI -	1.200 X 1.200
D2 -	0.750 X 2.100	W2 -	0.900 X 1.200
		V -	0.600 X 0.600

DETAILS OF AREA

TOTAL AREA (AS PER DEED)	16882 Sq
TOTAL AREA (AS PER SITE)	16629 Sq
GROUND FLOOR AREA	104.15 Sq
FIRST FLOOR AREA	105.76 Sq
SECOND FLOOR AREA	105.76 Sq
TOTAL COVERED AREA	314.67 Sq
% OF PLINTH AREA	62.57%
E.A.R	1.89

TITLE OF DRAWING

PLAN OF RESIDENTIAL BUILDING OF
 SMT SHOBHA SINHA, W/O SRI KRISHNA KUMAR
 ETWARI NAGAR, TELIWARA, HIRAPUR, (DHANBAD)
 UNDER MOUZA - DAMODARPUR NO- 14, OLD KH/1
 NO- 27, NEW KHATA NO- 180, OLD PLOT NO- 87
 NEW PLOT NO.- 1863, DIST- DHANBAD, (JHARKHA)

SIG. OF OWNER

SIG. OF ENGINEER

DRG. AT:-

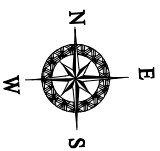
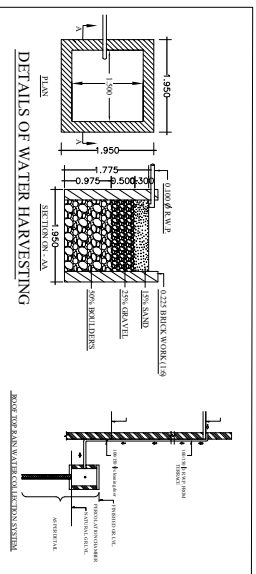
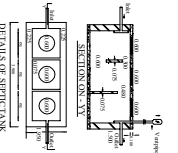
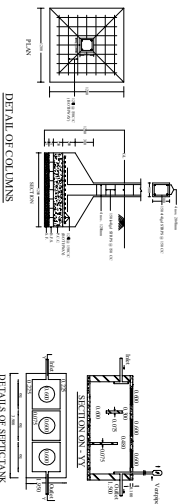
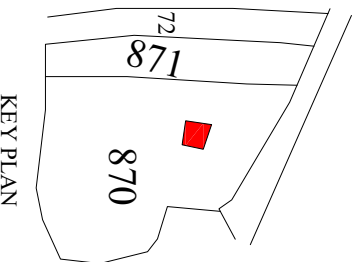
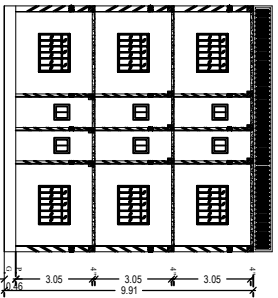
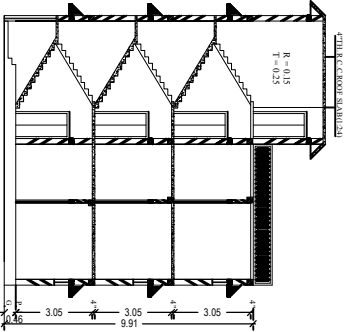
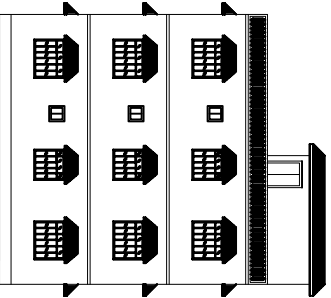
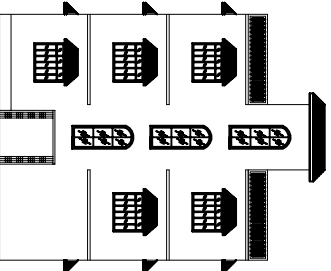

BRIEF SPECIFICATION

FOUNDATION :- R.C.C. (1:1.5:3) Column footing foundation
 PLINTH :- 12th R.C.C. (1:1.5:3) all round on plinth level
 FLOORING :- 1.5th 1.P.S. flooring over 3th P.C.C (1:3:1)
 SUPER STRUCTURE :- First class brick work in cement mortar (1:6)
 SLAB/BEAM & LINTEL :- All R.C.C. work (1:1.5:3)
 WOOD WORK :- All door & window frames of sal wood.
 PLASTERING :- 0.5th cement plaster (1:6) both side.

SCHEDULE

D -	1.000 X 2.100	W -	1.500 X 1.200
DI -	0.900 X 2.100	WI -	1.200 X 1.200
D2 -	0.750 X 2.100	W2 -	0.900 X 1.200
		V -	0.600 X 0.600

DETAILS OF AREA

TOTAL AREA (AS PER DEED)	16882 Sq
TOTAL AREA (AS PER SITE)	16629 Sq
GROUND FLOOR AREA	104.15 Sq
FIRST FLOOR AREA	105.76 Sq
SECOND FLOOR AREA	105.76 Sq
TOTAL COVERED AREA	314.67 Sq
% OF PLINTH AREA	62.57%
E.A.R	1.89

TITLE OF DRAWING

PLAN OF RESIDENTIAL BUILDING OF
 SMT SHOBHA SINHA, W/O SRI KRISHNA KUMAR
 ETWARI NAGAR, TELIWARA, HIRAPUR, (DHANBAD)
 UNDER MOUZA - DAMODARPUR NO- 14, OLD KH/1
 NO- 27, NEW KHATA NO- 180, OLD PLOT NO- 87
 NEW PLOT NO.- 1863, DIST- DHANBAD, (JHARKHA)

SIG. OF OWNER

SIG. OF ENGINEER

DRG. AT:-

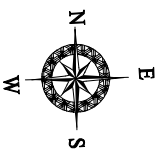
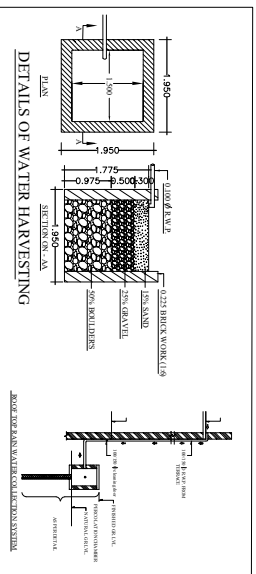
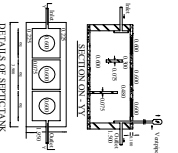
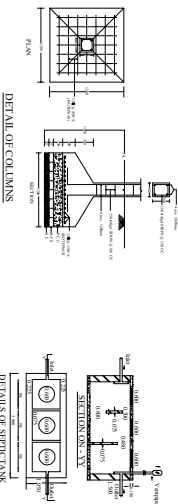
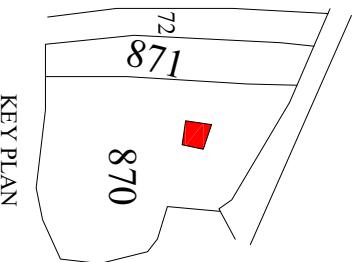
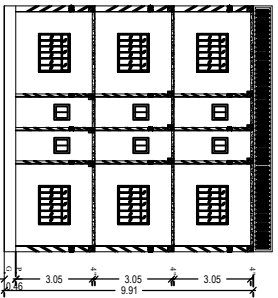
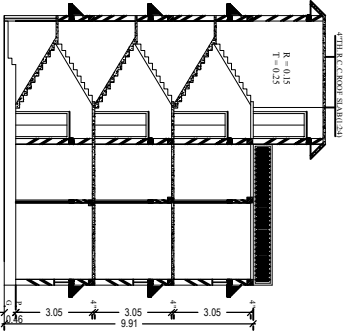
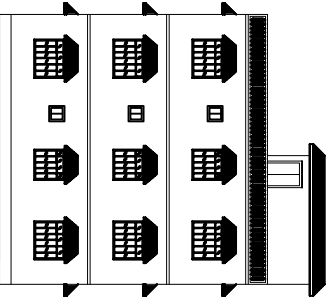
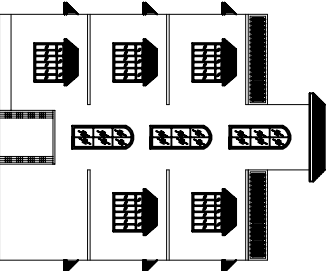

BRIEF SPECIFICATION

FOUNDATION :- R.C.C. (1:1.5:3) Column footing foundation
 PLINTH :- 12th R.C.C. (1:1.5:3) all round on plinth level
 FLOORING :- 1.5th 1.P.S. flooring over 3th P.C.C (1:3:1)
 SUPER STRUCTURE :- First class brick work in cement mortar (1:6)
 SLAB/BEAM & LINTEL :- All R.C.C. work (1:1.5:3)
 WOOD WORK :- All door & window frames of sal wood.
 PLASTERING :- 0.5th cement plaster (1:6) both side.

SCHEDULE

D -	1.000 X 2.100	W -	1.500 X 1.200
DI -	0.900 X 2.100	WI -	1.200 X 1.200
D2 -	0.750 X 2.100	W2 -	0.900 X 1.200
		V -	0.600 X 0.600

DETAILS OF AREA

TOTAL AREA (AS PER DEED)	16882 Sq
TOTAL AREA (AS PER SITE)	16629 Sq
GROUND FLOOR AREA	104.15 Sq
FIRST FLOOR AREA	105.76 Sq
SECOND FLOOR AREA	105.76 Sq
TOTAL COVERED AREA	314.67 Sq
% OF PLINTH AREA	62.57%
E.A.R	1.89

TITLE OF DRAWING

PLAN OF RESIDENTIAL BUILDING OF
 SMT SHOBHA SINHA, W/O SRI KRISHNA KUMAR
 ETWARI NAGAR, TELIWARA, HIRAPUR, (DHANBAD)
 UNDER MOUZA - DAMODARPUR NO- 14, OLD KH/1
 NO- 27, NEW KHATA NO- 180, OLD PLOT NO- 87
 NEW PLOT NO.- 1863, DIST- DHANBAD, (JHARKHA)

SIG. OF OWNER

SIG. OF ENGINEER

DRG. AT:-

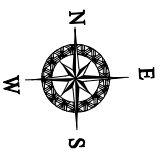
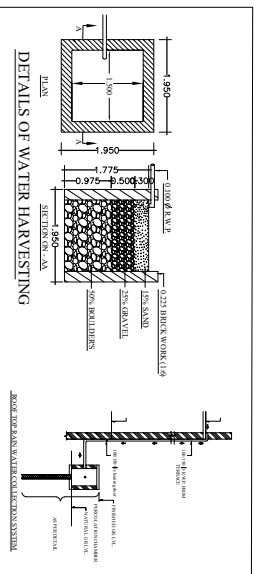
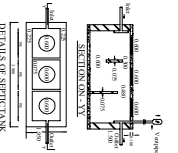
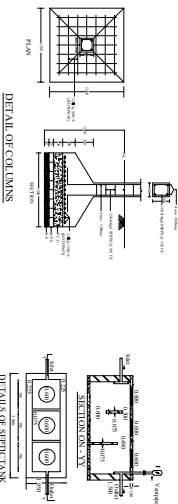
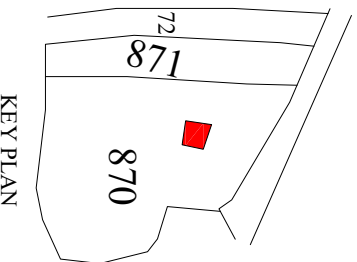
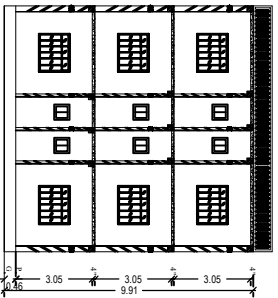
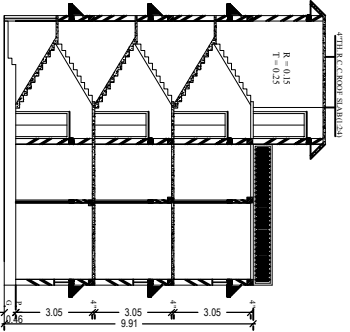
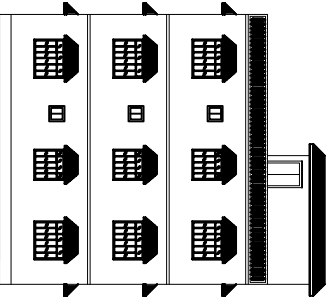
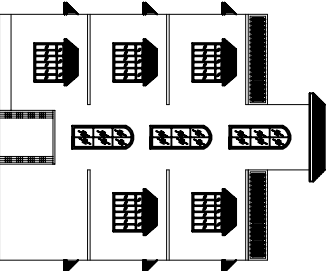

BRIEF SPECIFICATION

FOUNDATION :- R.C.C. (1:1.5:3) Column footing foundation
 PLINTH :- 12th R.C.C. (1:1.5:3) all round on plinth level
 FLOORING :- 1.5th 1.P.S. flooring over 3th P.C.C (1:3:1)
 SUPER STRUCTURE :- First class brick work in cement mortar (1:6)
 SLAB/BEAM & LINTEL :- All R.C.C. work (1:1.5:3)
 WOOD WORK :- All door & window frames of sal wood.
 PLASTERING :- 0.5th cement plaster (1:6) both side.

SCHEDULE

D -	1.000 X 2.100	W -	1.500 X 1.200
DI -	0.900 X 2.100	WI -	1.200 X 1.200
D2 -	0.750 X 2.100	W2 -	0.900 X 1.200
		V -	0.600 X 0.600

DETAILS OF AREA

TOTAL AREA (AS PER DEED)	16882 Sq
TOTAL AREA (AS PER SITE)	16629 Sq
GROUND FLOOR AREA	104.15 Sq
FIRST FLOOR AREA	105.76 Sq
SECOND FLOOR AREA	105.76 Sq
TOTAL COVERED AREA	314.67 Sq
% OF PLINTH AREA	62.57%
E.A.R	1.89

TITLE OF DRAWING

PLAN OF RESIDENTIAL BUILDING OF
 SMT SHOBHA SINHA, W/O SRI KRISHNA KUMAR
 ETWARI NAGAR, TELIWARA, HIRAPUR, (DHANBAD)
 UNDER MOUZA - DAMODARPUR NO- 14, OLD KH/1
 NO- 27, NEW KHATA NO- 180, OLD PLOT NO- 87
 NEW PLOT NO.- 1863, DIST- DHANBAD, (JHARKHA)

SIG. OF OWNER

SIG. OF ENGINEER

DRG. AT:-

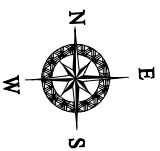
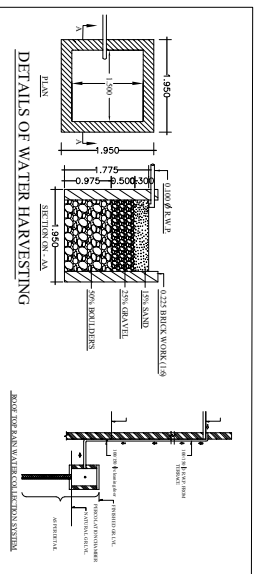
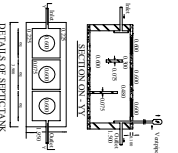
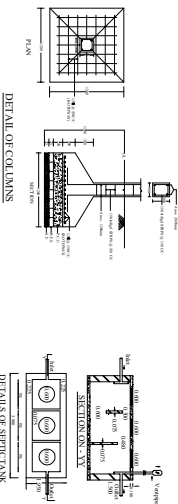
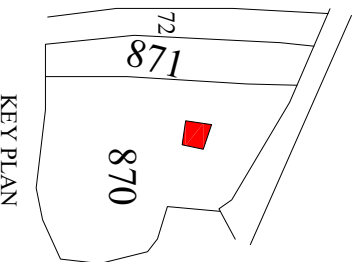
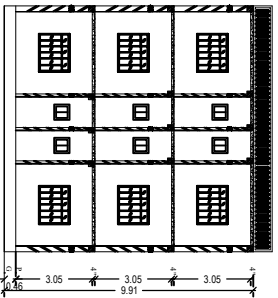
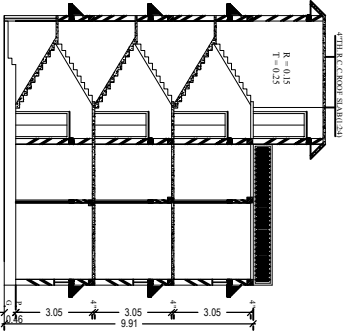
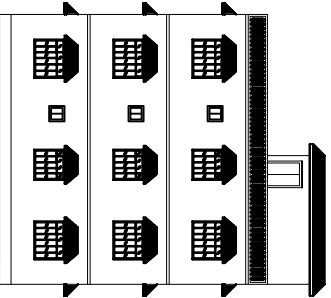
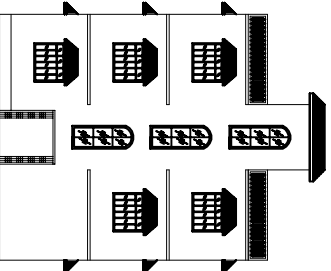

BRIEF SPECIFICATION

FOUNDATION :- R.C.C. (1:1.5:3) Column footing foundation
 PLINTH :- 12th R.C.C. (1:1.5:3) all round on plinth level
 FLOORING :- 1.5th 1.P.S. flooring over 3th P.C.C (1:3:1)
 SUPER STRUCTURE :- First class brick work in cement mortar (1:6)
 SLAB/BEAM & LINTEL :- All R.C.C. work (1:1.5:3)
 WOOD WORK :- All door & window frames of sal wood.
 PLASTERING :- 0.5th cement plaster (1:6) both side.

SCHEDULE

D -	1.000 X 2.100	W -	1.500 X 1.200
DI -	0.900 X 2.100	WI -	1.200 X 1.200
D2 -	0.750 X 2.100	W2 -	0.900 X 1.200
		V -	0.600 X 0.600

DETAILS OF AREA

TOTAL AREA (AS PER DEED)	16882 Sq
TOTAL AREA (AS PER SITE)	16629 Sq
GROUND FLOOR AREA	104.15 Sq
FIRST FLOOR AREA	105.76 Sq
SECOND FLOOR AREA	105.76 Sq
TOTAL COVERED AREA	314.67 Sq
% OF PLINTH AREA	62.57%