

(8)

Site Inspection

Date: 14/07/2024

1 File No.	MADA/BP/0026/2024
2 Owner Name	Smt. Amita Kumari
3 LTP	Sri Kam Pratab Singh

4 Schedule of Boundaries

East	Road
West	Same Plot
North	Same Plot
South	Same Plot

Plot Address	
--------------	--

Mouza: Kuramidih
 Khata: Old:-43, New:-74
 Plot: Old:-1155, New:-1332
 Area: 157.88 Sqmtr.

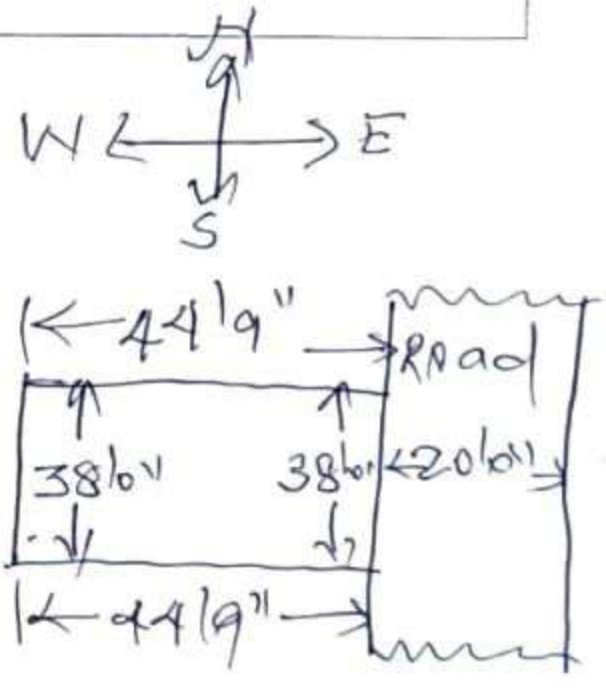

Site Inspection as per Site visit

Road width & Road type: 20'6" and Kachcher.
 Electric: NO
 Drain: NO
 Bore: NO
 Landmark: Royal wabi's (Kuramidih)

The above mentioned information about the plot is true and Site shown to JE is same for which I had applied for Map approval

Akash Sr.
(Signature of Land owner)

14/07/24

Sourav
(Sign of LTP/ LTP staff)

अभिप्रेत
 17/07/2017

श्री गंगा मनीष 129
 श्री गंगा मनीष 129

क्रेता - अनिता कुमारी
 क्रेता - अनिता कुमारी

जायदाद विवरण
 43 (तैतालीस) 1332 1155 1700 3.90 डिसेमिटर



गोहददी
 उत्तर - इरी प्लॉट का अंश
 दक्षिण - इरी प्लॉट का अंश
 पूर्व - पत्तावित सस्ता
 पश्चिम - इरी प्लॉट का अंश

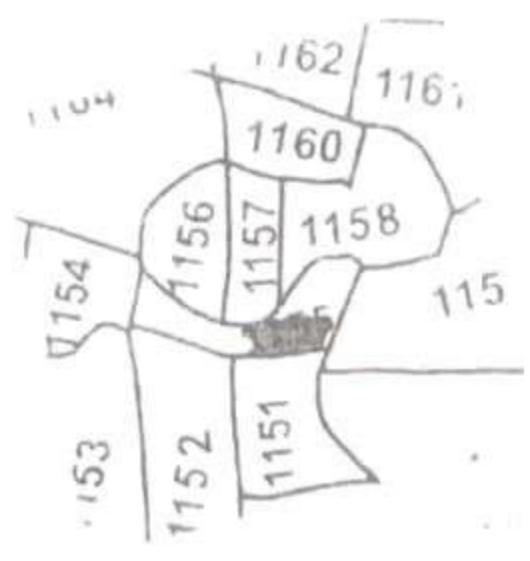
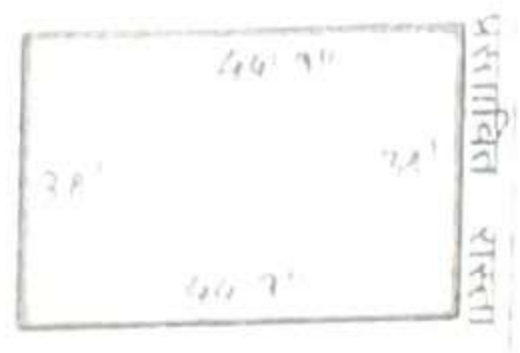

श्री गंगा मनीष 129

Anita Kumari

T.20